

Western Washington Hound Association
Running Order and Class Information
August 27-29, 2010

Driving Directions to King Co. Marymoor Park, Redmond, WA

Directions: From I-5 or I-405, take State Route 520 east to the West Lake Sammamish Parkway exit. At the bottom of the ramp, go right (southbound) on W. Lake Sammamish Parkway NE. The park entrance is the next left at the traffic light. Marymoor is also accessible by foot, bicycle or rollerblades via the Burke-Gilman/Sammamish River Trail.

- Judge:** Robyn Veenema and Kylie Bourke
- Opening/Closing:** 6/30/2010 8:00 AM - 8/11/2010 6:00 PM
- Height Order:** Small to Tall on Friday and Saturday, Tall to Small on Sunday.
- Class Schedule:** Friday: Exc Std, Exc Jww, Exc Fast
Saturday: Ring 1 – Exc Fast, Exc Std, Opn Std, Nov Std
Ring 2 – Opn Fast, Nov Fast, Nov Jww, Opn Jww, Exc Jww
Sunday: Ring 1 – Exc Std, Opn Std, Nov Std
Ring 2 – Nov Jww, Opn Jww, Exc Jww
- Start Times:** Friday: 1:00 PM, Saturday-Sunday 8:30 AM in Ring 1. Ring 2 about 15 minutes later.
Rings will alternate on Friday (only 1 judge). Rings will run at the same time on weekend.
- Conflicts:** We realize that this is a very busy show and we'll make every effort to accommodate conflicts with other show events. If you have a conflict, you **MUST** inform the gate steward before your normal run time so changes can be made. **Please let us know if there is a conflict so that we can help.** Once the rings have been torn down/changed, the class is officially over and you won't be able to run.
- Walkthroughs:** There will be split walkthroughs for Excellent Std and Jww and a single walkthrough for the other classes.
- Veterinarian:** (on Call) Dr. Terry Hartung & Dr. Kevin Cox – Redmond Fall City Animal Hospital
24376 NE Redmond Fall City Rd., Redmond, WA 98053 425-296-8036
- Workers Schedule:** We will be using the white board signup at the show (please help out where you can ☺). If you can help out with some of the class(es) that you're not running in, we'd appreciate it.
- Moveups:** The deadline for moveups is Monday August 23rd at 6PM. Moveups must be received in writing or email by that deadline. Day-to-Day moveups are being accepted for Saturday and Sunday.
- Shade Info:** The fields don't have any shade anywhere near the rings. Please plan to bring shade for yourselves and your dogs. **There will be a water hose and/or pool available to help cool the dogs down.**
- Day Parking:** Day parking is in the agility area on the soccer fields ONLY for \$4.00/day. **There is absolutely NO parking in the general Marymoor parking lots for any dog show events.**
- RV Parking:** The RV parking is for self contained vehicles only. Please note: There are NO hookups at this site (power or water). RV parking for agility is in the soccer field area only by previous reservation.
- Limited Shuttle Svc:** The agility area will have limited access to a golf cart to help ferry people between the conformation and agility areas. This will be on an as-available basis. Please check with the score table for information on the shuttle to other show areas.
- WWHA is offering two educational events on Saturday 1/2 hour after the show. Signup with Robin at the score table.**
- Agility Trial Tour:** The WWHHA is offering an "Agility Trial Tour" for interested spectators and/or exhibitors. This will help you understand more about the sport of dog agility. We'll explain the classes, divisions, and basic rules of AKC agility as well as some basic training info and ways to get started. It may also include a brief tour of the ring (not while the dogs are running !!), information on how to enter a show, and other information.
- New Exhibitor Briefing:** This activity will assist new exhibitors understand the workings of an agility trial, where to get their questions answered and how to be a successful exhibitor in this sport. We'll show you how to help out at a show, how the schedules work, how to get your dog measured, and other general New Exhibitor Information.

W. Lk. Sammamish Pkwy.

Marymoor Park



Breed / Obed / Rally rings



HWY 520

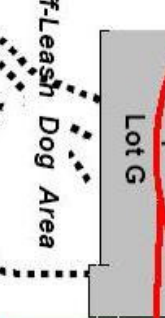
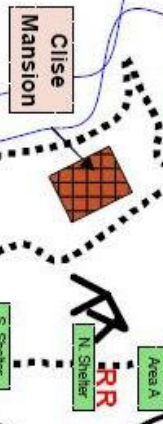
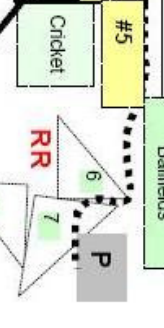
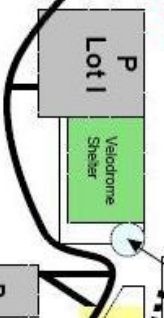
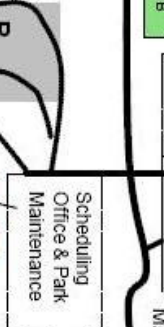
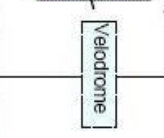
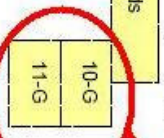
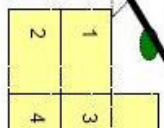
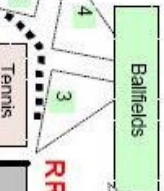

Agility rings and ALL agility parking are in Soccer Fields 7,8,9. This includes day parking and overnight RV parking.
Day parking is \$4.00 / day
RV parking is \$35.00 / night (self-contained only)
There is ABSOLUTELY NO agility parking in the general parking lots. All show parking MUST be in the designated soccer fields. Failure to adhere to the show committee parking rules could result in a bench hearing and/or towing of your vehicle.

Off-Leash Dog Area

Off-Leash Dog Area

King County

Marymoor Park
6046 W. Lake Sammamish Pkwy. NE
Redmond, WA 98052

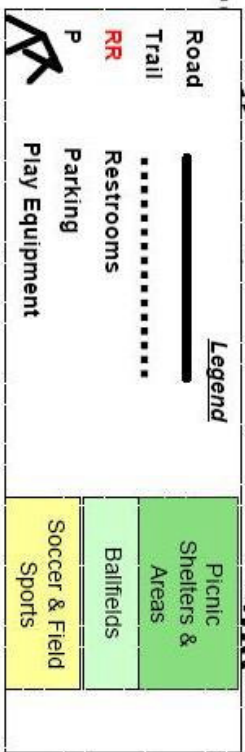

TRIAL ENTRY STATISTICS

Preliminary running order contingent on move-ups not yet received.

TRIAL:

	R. Total	Fri						P. Total	PREFERRED					Total 227
		REGULAR												
		8"	12"	16"	20"	24"			4"	8"	12"	16"	20"	
TOTAL STANDARD	85							9						94
EXC A, B	85	10	16	16	26	14	3	9	3	2	1	3	0	94
TOTAL JWW	94							9						103
EXC A, B	94	10	19	17	28	17	3	9	3	2	1	3	0	103
TOTAL FAST	29							1						30
EXC A, B	29	3	6	6	9	3	2	1	0	0	1	0	0	30
JUDGE 1 TOTAL	<i>Robyn Veenema</i>				227			RING 1 TOTAL			124			
								RING 2 TOTAL			103			

TRIAL:

	R. Total	Sat						P. Total	PREFERRED					Total 457
		REGULAR												
		8"	12"	16"	20"	24"			4"	8"	12"	16"	20"	
TOTAL STANDARD	170							19						189
OPEN	34	3	5	4	17	5	0	2	0	0	0	1	1	36
NOV A, B	26	4	4	6	8	4	0	5	0	2	0	1	2	31
EXC A, B	110	12	20	17	39	18	4	12	4	3	2	2	1	122
TOTAL JWW	174							18						192
OPEN	33	5	3	8	14	3	0	1	0	0	0	1	0	34
NOV A, B	22	3	3	3	7	6	0	5	0	2	0	0	3	27
EXC A, B	119	13	21	17	44	20	4	12	4	3	2	3	0	131
TOTAL FAST	71							5						76
OPEN	15	1	2	3	6	3	0	2	1	1	0	0	0	17
NOV A, B	24	2	4	3	11	4	0	1	0	0	0	0	1	25
EXC A, B	32	2	7	6	13	2	2	2	0	1	1	0	0	34
JUDGE 1 TOTAL	<i>Robyn Veenema</i>				223			RING 1 TOTAL			223			
JUDGE 2 TOTAL	<i>Kylie Bourke</i>				234			RING 2 TOTAL			234			

TRIAL:

	R. Total	Sun						P. Total	PREFERRED					Total 381
		REGULAR												
		8"	12"	16"	20"	24"			4"	8"	12"	16"	20"	
TOTAL STANDARD	167							21						188
OPEN	34	4	3	4	15	8	0	4	0	1	0	1	2	38
NOV A, B	26	5	3	5	9	4	0	6	0	2	0	1	3	32
EXC A, B	107	13	19	17	34	20	4	11	4	3	2	1	1	118
TOTAL JWW	173							20						193
OPEN	32	5	2	7	15	3	0	3	0	1	0	1	1	35
NOV A, B	25	3	3	3	8	8	0	6	0	2	0	0	4	31
EXC A, B	116	15	21	17	36	23	4	11	4	3	2	1	1	127
TOTAL FAST	0							0						0
OPEN	0	0	0	0	0	0	0	0	0	0	0	0	0	0
NOV A, B	0	0	0	0	0	0	0	0	0	0	0	0	0	0
EXC A, B	0	0	0	0	0	0	0	0	0	0	0	0	0	0
JUDGE 1 TOTAL	<i>Robyn Veenema</i>				193			RING 1 TOTAL			188			
JUDGE 2 TOTAL	<i>Kylie Bourke</i>				188			RING 2 TOTAL			193			